



# 5x8 Galvanized Tilt Trailer Assembly



Figure 1



This booklet will guide you through unpacking and assembling your new Sure-Trac tilt bed trailer.

Figure 2



Cut the banding holding the two trailers together. Lift the top trailer off. Use caution as fenders and other parts are packed between the trailers and can be damaged when unstacking.

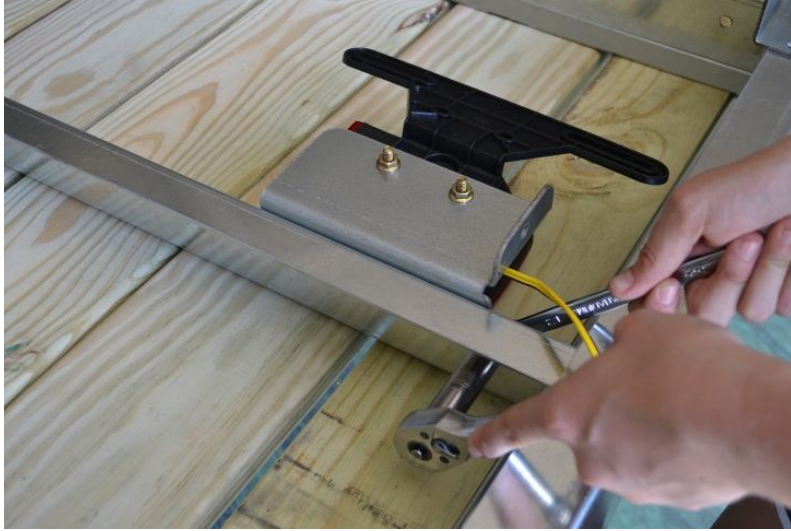
Figure 3



Remove the wood blocks and trailer parts from the bottom trailer.

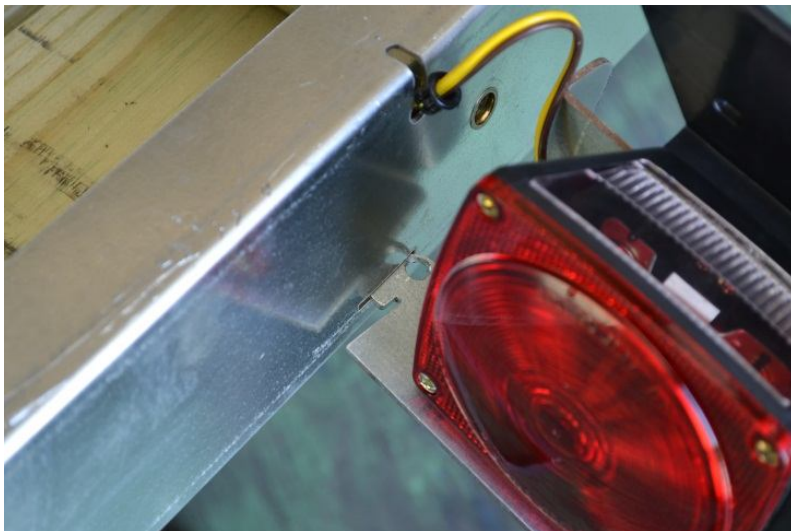


Figure 4



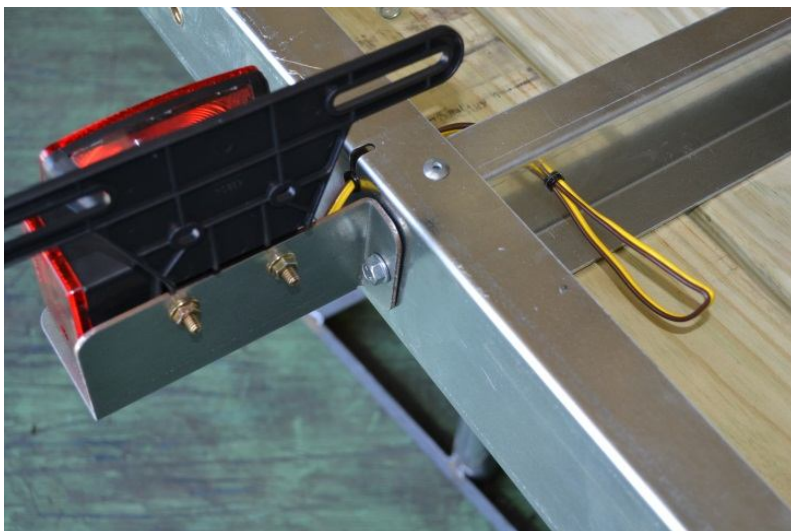
Unbolt the light brackets from their storage positions. (Figure 4) You will not re-use the nut from the light bracket but you will need the bolt.

Figure 5



Insert the tab into the slot on the trailer side frame (Figure 5) and slide the bracket to the rear to fully engage the tab.

Figure 6



Install the bolt you removed from the light bracket. The bolt will tighten into the rivet-nut that is in the side of the trailer. Insert the grommet into the frame hole to protect the wire going through the side frame. Feed the excess wire through the bolt hole that the light bracket was stored in and insert the grommet to protect the folded over wire. (Figure 6) Repeat this process for the 3 other tail light.

Figure 7



Place the axle into the shackles on the side frame of the trailer. (Figure 7) The large formed eye on the spring should go to the front of the trailer.

Figure 8



Hammer the large serrated shackle bolt (Figure 8) into the front shackle until the head touches the shackle side (Figure 9). These bolts are shipped in the hardware bag.

Figure 9





Figure 10



Install the 5/16 x 3-1/4 bolts and lock nuts over the spring and into the rear shackles. These bolts and nuts are also in the hardware bag. Tighten these bolts to 15 lbf.

Figure 11



Tighten the front shackle bolts using an impact wrench. Be sure to hold the bolt with a wrench so that the bolt does not turn. Spinning this bolt in the shackle will lead to axle mount failure. Tighten the nut until the shackle almost touches the spring sides.

Figure 12



Place the tongue into the tongue channel on the trailer. And align the holes. (Figure 12)

Figure 13



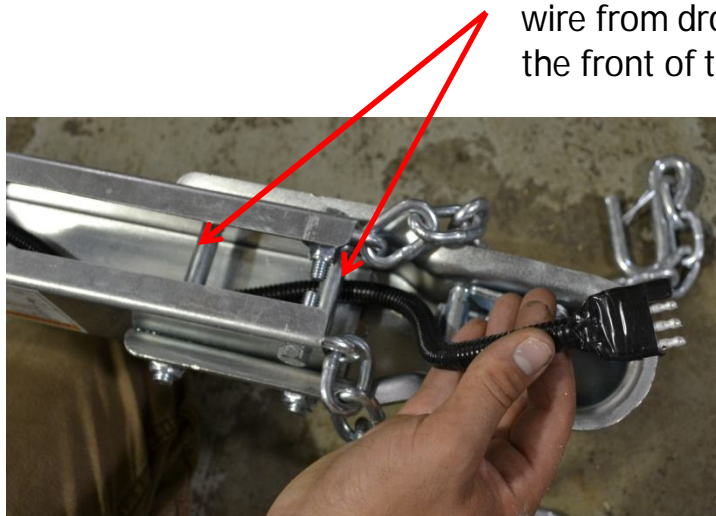
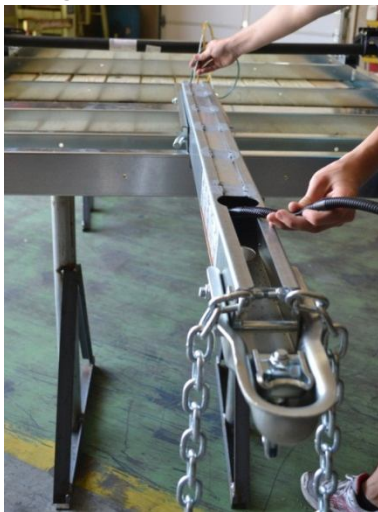
Insert the 9/16 x 4 pivot bolt into the tongue. Install the nylon lock nut and tighten until the sides of the rail start to touch the tongue.

Figure 14



Insert the front pin and cotter through the tongue and the tongue mount.

Figure 15



Feed the trailer wiring harness through the tongue and out the front so that the coupler mounting bolts keep the wire from dropping out the front of the tongue.



Figure 16



Flip the trailer and support it on sturdy stands so that you can finish the assembly. Remove the 3 self tapping screws installed in the tongue. Insert the jack through the tongue using caution not to damage the wiring harness.

Figure 17



Tighten the 3 self tapping screws into the pre drilled holes in the tongue. Tighten to 10 lbf.

Figure 18



Install both fenders by bolting through the fender brackets and into the preplaced nuts in the frame. Use the 5/16-18 x  $\frac{3}{4}$  bolts from the hardware bag. Tighten all 4 bolts on each fender to 15 lbf.

Figure 19



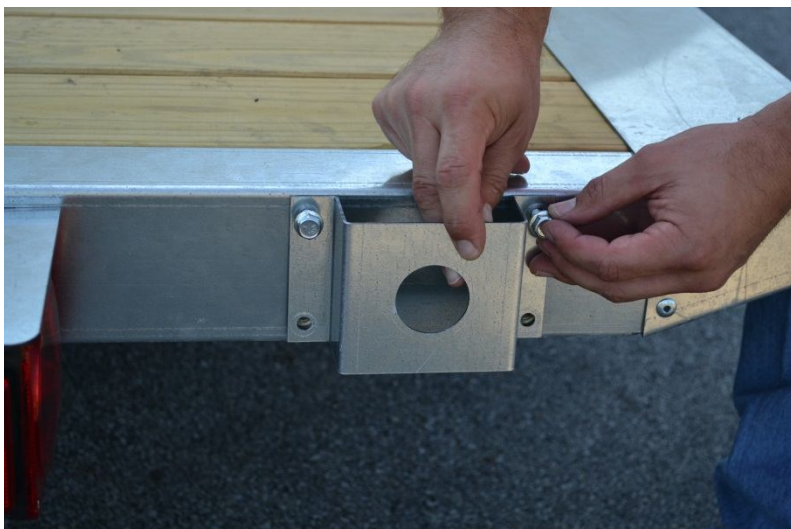
Install the tires and tighten the lug nuts (from the hardware bag) to 100 lbf of torque. Be sure and put the coned surface of the nut against the rim. Use a criss cross pattern to tighten the lug nuts working up to the final torque in three stages of tightening. Re-torque the lug nuts after 25, 50 and 100 miles of travel.

Figure 20



Install the tire stops on the front of the trailer using the hardware removed earlier. Place a bolt in each corner of the tire stop and use the serrated nuts to secure them. Tighten to 15 lbf of torque.

Figure 21



Using the 5/16-18 x 3/4 bolts from the hardware bag, install the stake pockets, 2 per side of the trailer; and tighten the bolts to 15 lbf.

\*Note, if you are installing a factory side board kit, do not install the stake pockets. The sideboard kit instructions are at the end of this manual.



Figure 22



When towing the trailer, the front pin must be installed with its keeper or cotter pin through it. This prevents the trailer from tipping up.

Figure 23



To tilt the trailer, ensure that the trailer is secure to the towing ball of the tow vehicle. Then, remove the cotter and pull the pin from the tongue. The trailer can now be tilted by lifting on the front of the trailer frame.

Figure 24



Trailer shown tilted without tow vehicle for demonstration purposes only. Tilting the trailer while not attached to the tow vehicle can be dangerous and could result in personal injury.

Figure 25



An optional side board kit with spare tire mount can be installed on your trailer.

Figure 26



Remove all 4 of the stake pockets, if installed, and keep the bolts. Place a side rail onto the trailer, inside of the fender, with the upright reinforcements facing out. Both side rails are the same and work on either side.

Figure 27



Reinstall the bolts through the uprights and into the rivet nuts. Tighten to 15 lbf.



Figure 28



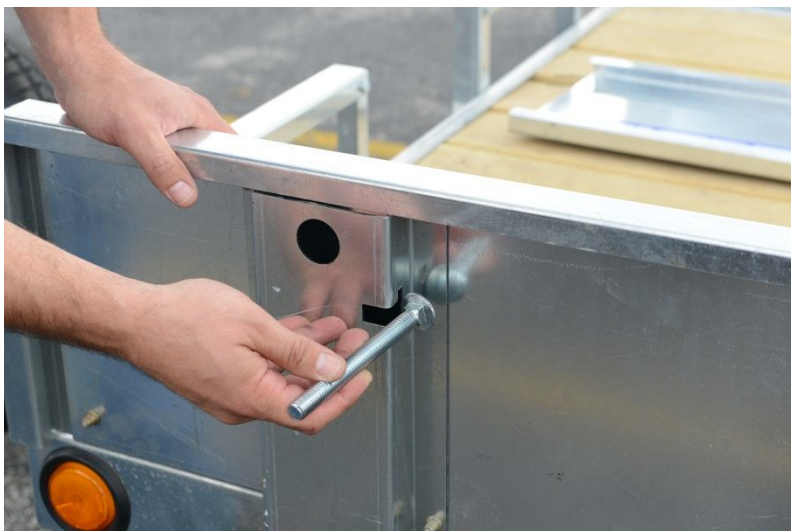
Slide an end gate into the front and the back of the side rails. The end gates are identical and can be used in the front or the rear.

Figure 29



The end gates can be nested into each other and placed at either the front or the back of the trailer when hauling long items that won't fit inside the gates.

Figure 30



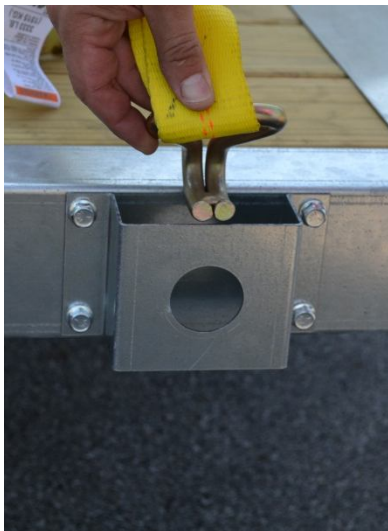
The slot in the upright of the sideboard kit is for mounting a spare tire to the trailer. Slide the included carriage bolt into the slot from the side and pull it away from the trailer to seat the square head into the slot.

Figure 31



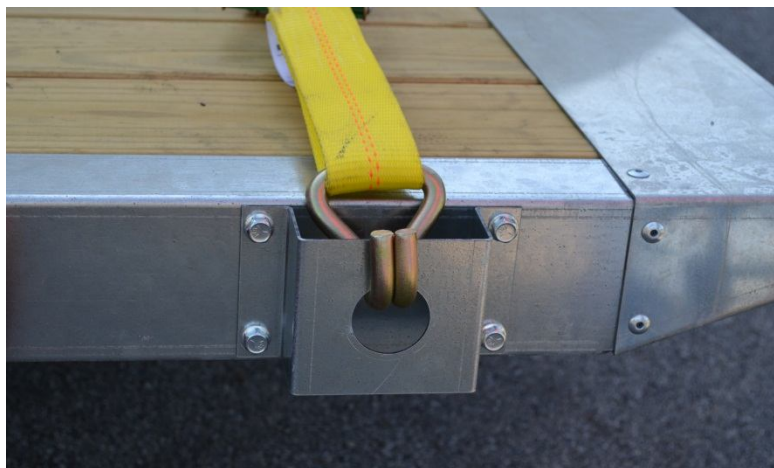
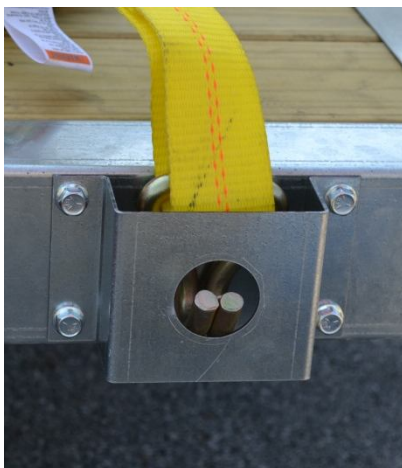
Place the tire over the bolt and tighten the included lock nut to hold the tire in place against the side of the trailer.

Figure 32-33



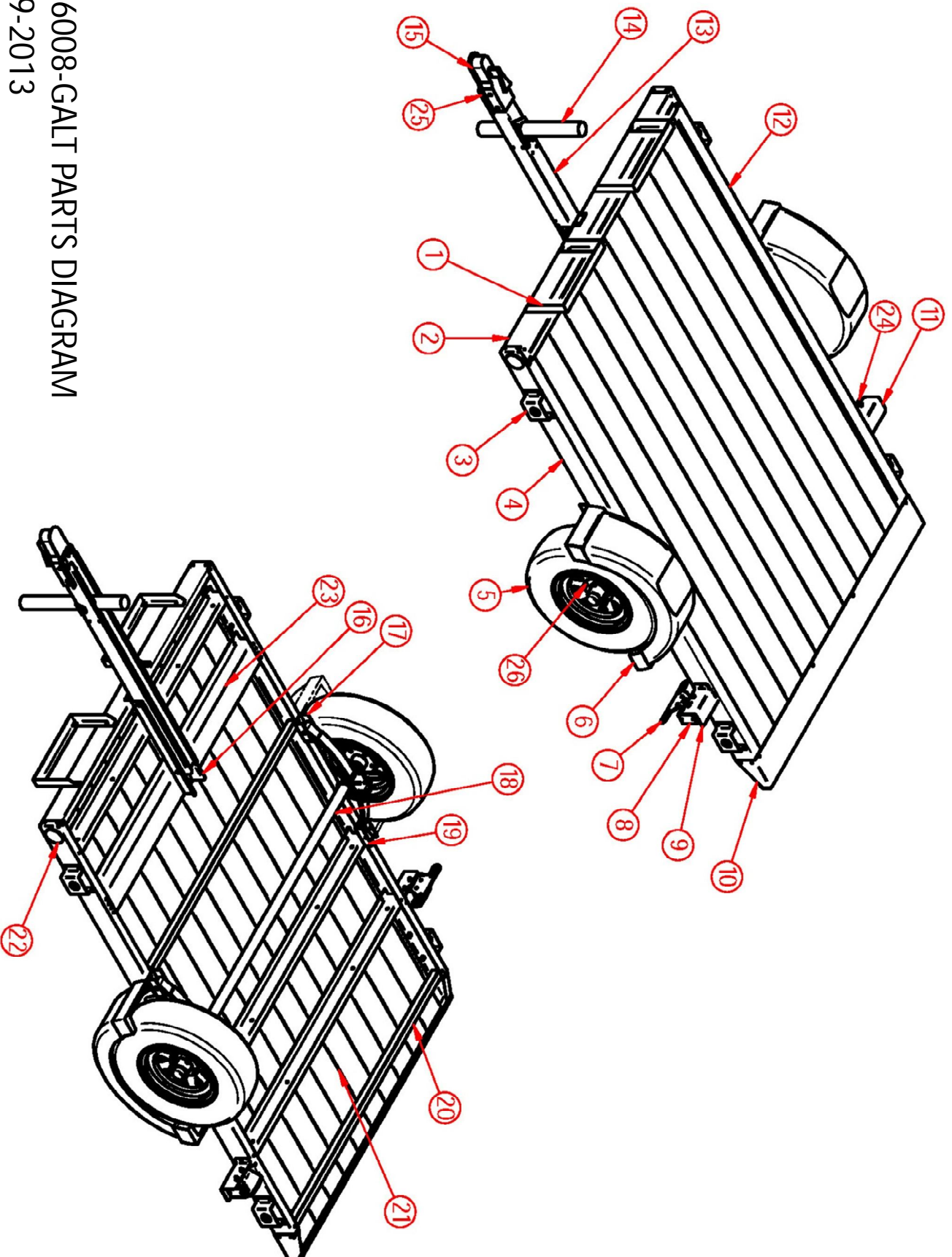
The stake pockets are designed to be used as tie down points. Most standard 2" straps have a wire formed hook that fits inside the pocket by twisting it in. Roll the strap hook into place as shown in Figure 32-33. The hook will not fall out when slacked (Figure 34), and it is located correctly when tension is applied (Figure 35).

Figure 34-35





ST6008-GALT PARTS DIAGRAM  
4-9-2013



## ST6008-GALT PARTS LIST

ID	Part #	Description	Qty	Part#	Decals	Qty
1	70015	Fab, Tire Stop	2	ST4069	Label, Sure Trac 15.6	2
1a	70018	Screw, 5/16-18 x 3/4 HH Serr. Gr 5 zinc	4	ST3527	Label, Bumper Pull Combo	1
1b	30624	Nut, 5/16-18 whiz flange serrated	4	32154	Decal, Patent Pending 1 x 6	1
2	70006	Fab, Front Frame	1	ST1273	Label, WWW.sure-trac.com on clear	1
3	70003	Fab, Stake Pocket Bolted	4	ST3637	Label, Final Inspection	1
3a	30624	Nut, 5/16-18 whiz flange serrated	4			
3b	70020	Rivet nut 5/16-18 .027-.150 Ribbed STL Z	4	* Rivet Nuts- Part 70020 require installation tool		
4	70008	Fab, Side Frame Left	1			
5	ST3287	Wheel assly, 13 silver mod	2			
6	70032	Fender, grey 13inch wheel	2			
6a	70001L	Fab, fender brace left	1			
6b	70001R	Fab, fender brace right	1			
6c	70018	Screw, 5/16-18 x 3/4 HH Serr. Gr 5 zinc	4			
6d	70020	Rivet nut 5/16-18 .027-.150 Ribbed STL Z	4			
7	ST1173	Hanger, License Plate plastic	1			
8	ST1175	Light, Tail License Illum Red 12V	1			
9	70016	Fab, Light Bracket B	1			
9a	70018	Screw, 5/16-18 x 3/4 HH Serr. Gr 5 zinc	1			
9b	70020	Rivet nut 5/16-18 .027-.150 Ribbed STL Z	1			
10	70007	Fab, Rear Tilt Frame	1			
11	70017	Fab, Light Bracket B mir	1			
11a	70018	Screw, 5/16-18 x 3/4 HH Serr. Gr 5 zinc	1			
11b	70020	Rivet nut 5/16-18 .027-.150 Ribbed STL Z	1			
12	70009	Fab, Side Frame Right	1			
13	70040	Tongue W/A	1			
14	ST7089	Jack, A-Fram 5k ZN plated	1			
14a	70021	Screw, 5/16-18 x 1/2 HH Trilobe	3			
14b	ST6686	Foot Plate Small bolt on	1			
15	70023	Coupler 2 in ball 3 wide CLII 3500 ZN	1			
15c	70026	Screw, 1/2-13 x 4 HH GR5 ZN	2			
15d	70027	Nut, 1/2-13 Nylon Lock GR5 ZN	2			
16	70014	Fab, Tilt Tongue Bracket	1			
16a	70022	Screw, 9/16-12 x 4 HH Gr 5 ZN	1			
16b	70024	Nut, 9/16-12 Nylon Lock, Zinc	1			
16c	70025	Pull Pin, 5/8 x 4.5 with Cotter	1			
17	70004	Fab, Front Shackle Mount D	2			
17a	ST1015	Screw, 9/16-18x3 Shackle Bolt Zinc	1			
17b	ST1016	Nut, 9/16-18 for Shackle Bolt	1			
18	70031	Axle, 2k idler 58.5/70 EZ slipper	1			
19	70005	Fab, Rear Shackle Mount	2			
19a	ST1737	Bolt, 5/16-18 x 3-1/4, HH GR5	1			
19b	ST1819	Nut, 5/16 Nylon Lock	1			
20	70010	Fab, Crossmember Z	5			
21	ST1170	Board, 5/4 x 8ft treated	10			
21a	ST1007	Screw, 12-14 x 2 tek dek screw	3			
22	ST2116	Light, Recessed Refl Rnd 2.5 Amber 12V	2			
22a	ST2117	Grommet, 2-1/2 Round Flush W/Wire	1			
23	70041	Tube CM W/A 5W	1			
24	ST1174	Light, Surface Mt Red 12v	1			
25	ST1014	Chain, Trailer Safety with Hook 27	2			
25a	1294	Washer, Flat 3/8 Zinc	1			
25b	102055	Screw, 3/8-16 x 1-1/4 HH GR5 Zinc	1			
25c	70028	Nut, 3/8-16 Nylon Lock GR5 ZN	1			
26	31206	Nut, Cone lug 1/2-20	10			
27	ST1108	Wire Harness, 4 pole 30 ft	1			
27a	ST1107	Loom, 3/8 Plastic Wire	7			



**Sure-Trac™ Trailer Warranty Registration Form**

Trailer Model: \_\_\_\_\_ Date: \_\_\_\_\_

Vehicle Identification Number (VIN): \_\_\_\_\_

Owners Name: \_\_\_\_\_ Phone Number: \_\_\_\_\_

Street: \_\_\_\_\_

City, State Zip: \_\_\_\_\_

Primary Use: \_\_\_\_\_

Store and Location where purchased: \_\_\_\_\_ Delivery Date: \_\_\_\_\_

Store Representative: \_\_\_\_\_ Signature: \_\_\_\_\_

(Fold to conceal information, tape closed, affix postage and mail)



Name: \_\_\_\_\_

Address: \_\_\_\_\_

City, State Zip: \_\_\_\_\_

PLACE  
POSTAGE  
HERE

**Novae Corp.  
One Novae Parkway  
Markle, IN 46770**